

## 232 SÜRME SERİ PVC PROFİL SİSTEMİ

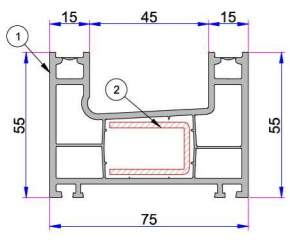

- Sürme Kasa Profili (Çift Ray)**  
P.A.232.1106.600.0.00.01
- Destek Sacı (30x20x30)**  
1,2mm - 34022 - 12006  
1,5mm - 34022 - 15006  
2 mm - 34022 - 20006

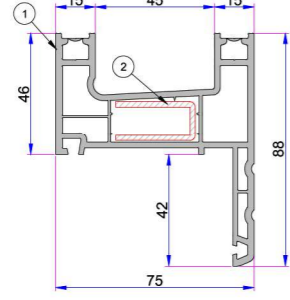

- Sürme Kasa Profili (Dekoratif Pervazlı)**  
P.A.232.1107.600.0.00.01
- Destek Sacı (30x15x30)**  
1,2mm - 34022 - 12034  
1,5mm - 34022 - 15034  
2 mm - 34022 - 20034

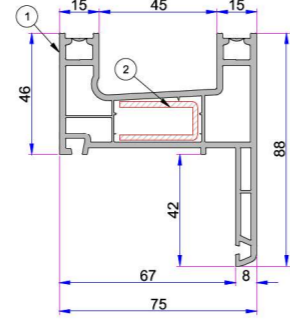

- Sürme Kasa Profili (Düz Pervazlı)**  
P.A.232.1110.600.0.00.01
- Destek Sacı (30x15x30)**  
1,2mm - 34022 - 12034  
1,5mm - 34022 - 15034  
2 mm - 34022 - 20034

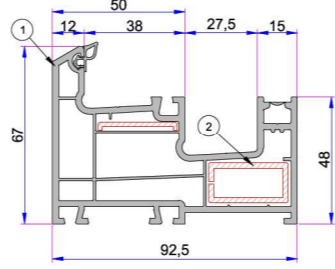

- Tek Ray Sürme Kasa Profili**  
P.A.232.1105.600.0.BC.01
- Destek Sacı (30x15)**  
1,2mm - 34022 - 12135  
1,5mm - 34022 - 15125  
2 mm - 34022 - 20125

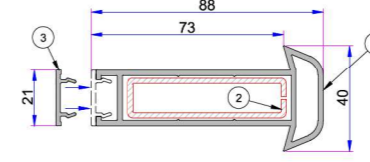

- Üniversal Kalın Bağ Profili**  
P.A.058.5000.600.0.00.19
- Destek Sacı (15x60)**  
1,2mm - 34022 - 12123  
1,5mm - 34022 - 15123  
2 mm - 34022 - 20123
- Üniversal Kalın Bağ Kapak Profili**  
P.A.058.5707.600.0.00.19

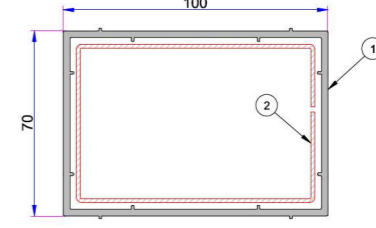

- Kutu Profili (70x100)**  
P.A.070.5202.600.0.00.19
- Destek Sacı (60x90)**  
1,2mm - 34022 - 12121  
1,5mm - 34022 - 15121  
2 mm - 34022 - 20121

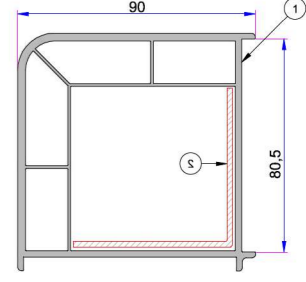

- 90° Köşe Profili**  
P.A.080.5100.600.0.00.19
- Destek Sacı (60x60)**  
1,2mm - 34022 - 12306  
1,5mm - 34022 - 15306  
2 mm - 34022 - 20306

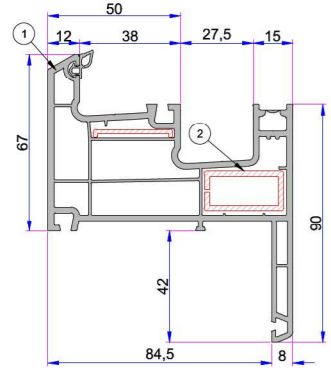

- Tek Ray Sürme Kasa (Pervazlı)**  
P.A.242.1114.600.0.00.01
- Destek Sacı (30x15)**  
1,2mm - 34022 - 12135  
1,5mm - 34022 - 15135  
2 mm - 34022 - 20135

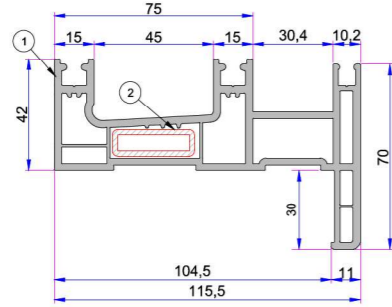

- İç Sineklik Raylı Sürme Kasa Profili**  
P.A.242.1104.600.0.00.01
- Destek Sacı (30x10)**  
1,2mm - 34022 - 12107  
1,5mm - 34022 - 15107  
2 mm - 34022 - 20107

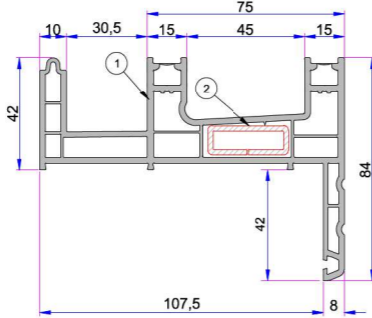

- Dış Sineklik Raylı Sürme Kasa Profili**  
P.A.242.1109.600.0.00.01
- Destek Sacı (30x11)**  
1,2mm - 34022 - 12107  
1,5mm - 34022 - 15107  
2 mm - 34022 - 20107

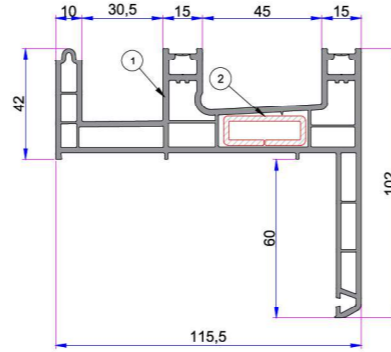

- 60mm Pervazlı - Sineklikli Kasa Profili**  
P.A.232.1115.600.0.00.01
- Destek Sacı (30x11)**  
1,2mm - 34022 - 12107  
1,5mm - 34022 - 15107  
2 mm - 34022 - 20107

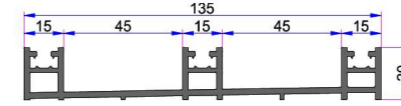

Alm. Sürme 3 Raylı Eşik Profili  
AD16-035



Alüminyum Sürme Ray  
AD16-014 PRES

Alüminyum Sürme Ray  
AD-16-053

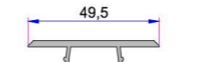

PVC Kanat Arka Kapama Profili  
P.A.232.5701.650.0.00.19

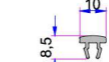

Kasa Kanal Kapama  
P.A.232.5703.600.0.00.19

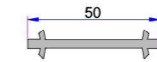

Bağ Profili  
P.A.050.5001.600.0.00.19



PVC Kanat Ara Bindirme  
P.A.232.5301.650.0.00.19

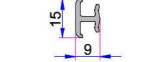

Ortak Kısa Bağ Profili  
P.A.099.5004.600

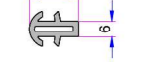

Kısa Bağ Profili  
P.A.099.5003.600

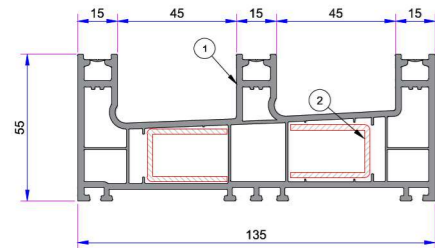

- Üç Raylı Kasa Profili**  
**Profil YENİ Yapılacak**
- Destek Sacı (30x20x30)**  
1,2mm - 34022 - 12006  
1,5mm - 34022 - 15006  
2 mm - 34022 - 20006

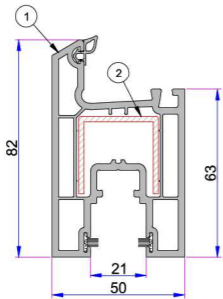

- Sürme Kanat Profili (Kıl Fitilli)**  
P.A.232.2300.600.0.BC.01
- Destek Sacı (29x30x29)**  
1,2mm - 34022 - 12002  
1,5mm - 34022 - 15002  
2 mm - 34022 - 20002

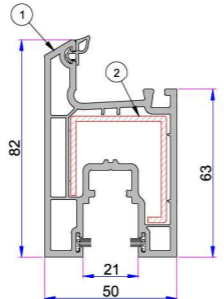

- Statik Sürme Kanat Profili (Kıl Fitilli)**  
P.A.232.2308.600.0.BC.01
- Destek Sacı (30x36x40x7)**  
1,2mm - 34022 - 12036  
1,5mm - 34022 - 15036  
2 mm - 34022 - 20036

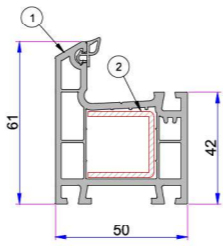

- 332 Kasa Profili**  
P.A.332.1000.600.0.BC.01
- Destek Sacı (25x25x25)**  
1,2mm - 34022 - 12003  
1,5mm - 34022 - 15003  
2 mm - 34022 - 20003

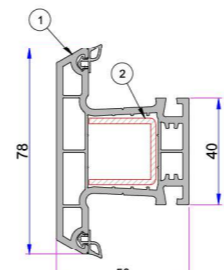

- 332 Orta Kayıt Profili**  
P.A.332.3000.600.0.BC.01
- Destek Sacı (25x25x25)**  
1,2mm - 34022 - 12003  
1,5mm - 34022 - 15003  
2 mm - 34022 - 20003

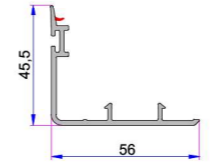

PVC Kanat Ara Bindirme Contası  
P.A.232.5700.600.0.00.01

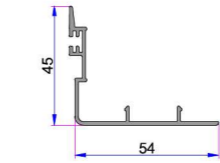

Alm. Kanat Arka Kapama  
16051.601.5.1.1.9016

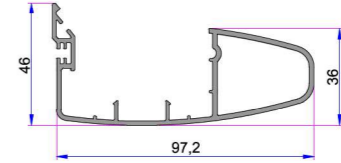

Alm. Kanat Arka Kapama Griyaj Profili  
16028.601.5.2.0.9016

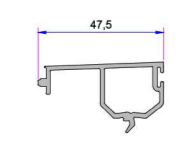

Tek Ray Kanal Kapama  
P.A.232.5710.600.0.00.19

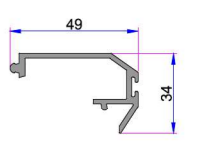

Alm. Kasa Kanal Kapama Profili  
AD 16 - 013

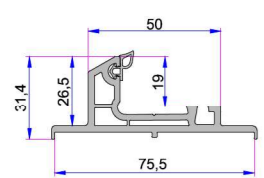

Çift Ray Adaptör Profili  
P.A.232.5800.600.0.BC.19

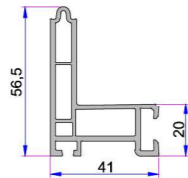

Sineklik Ray Profili  
P.A.232.5802.600.0.00.19

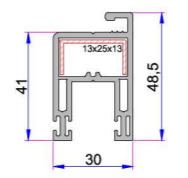

Sürme Sineklik Kanat Profili  
P.A.242.2305.600.0.00.01

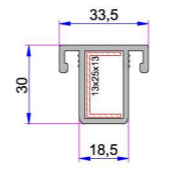

Sürme Sineklik Orta Kayıt Profili  
P.A.242.3200.600.0.00.01

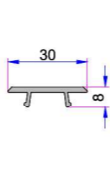

Sürme Sineklik Kanat Kapama  
P.A.242.5701.600

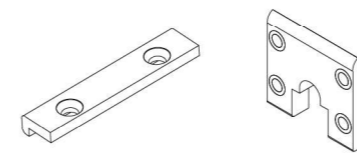

Sürme Üst Yatak Parçası  
34009 - 36010

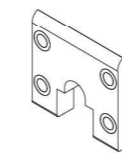

Sürme Alın Kapak  
34009 - 46010

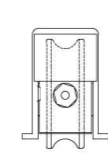

Sürme Teker  
34009 - 18030

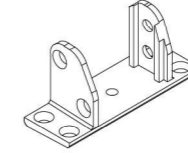

232 Kanattan Orta Kayıt Bağlantı Takozu  
34007 - 14030

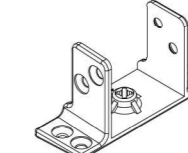

332 Orta Kayıt Bağlantı Takozu  
34007 - 11080

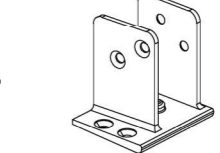

Kasa-Kasa Bağlantı Takozu  
34007-14020

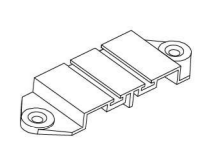

Çift Ray Sızdırmazlık Parçası  
34009 - 26010

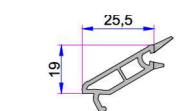

Tek Cam Çıtası (4 mm)  
P.A.332.4000.600.0.HC

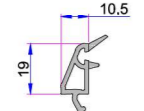

Çift Cam Çıtası (20 mm)  
P.A.332.4100.600.0.HC

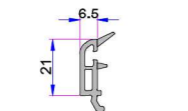

Çift Cam Çıtası (24 mm)  
P.A.532.4500.600.0.HC

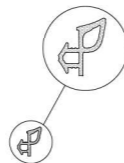

Kasa Contası

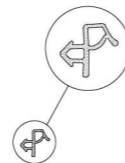

Kanat Contası

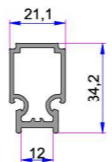

Alm. Çift Kanat Adaptörü  
16011.601.5.1.1.9016

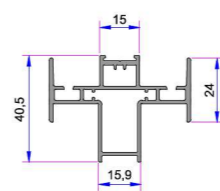

Alm. Kulaklı Çift Kanat Adaptörü  
Profil YENİ Yapılacak

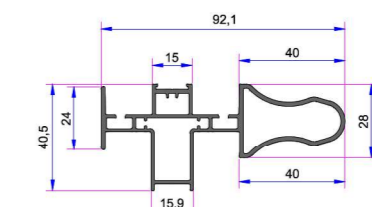

Alm. Griyajlı Çift Kanat Adaptörü  
Profil YENİ Yapılacak

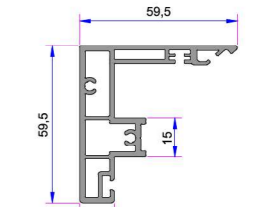

Üç Bölmeli Sürme Alm. Orta Kayıt Profili  
Profil YENİ Yapılacak